

**FLOOR PLANS**  
Scale 1:100

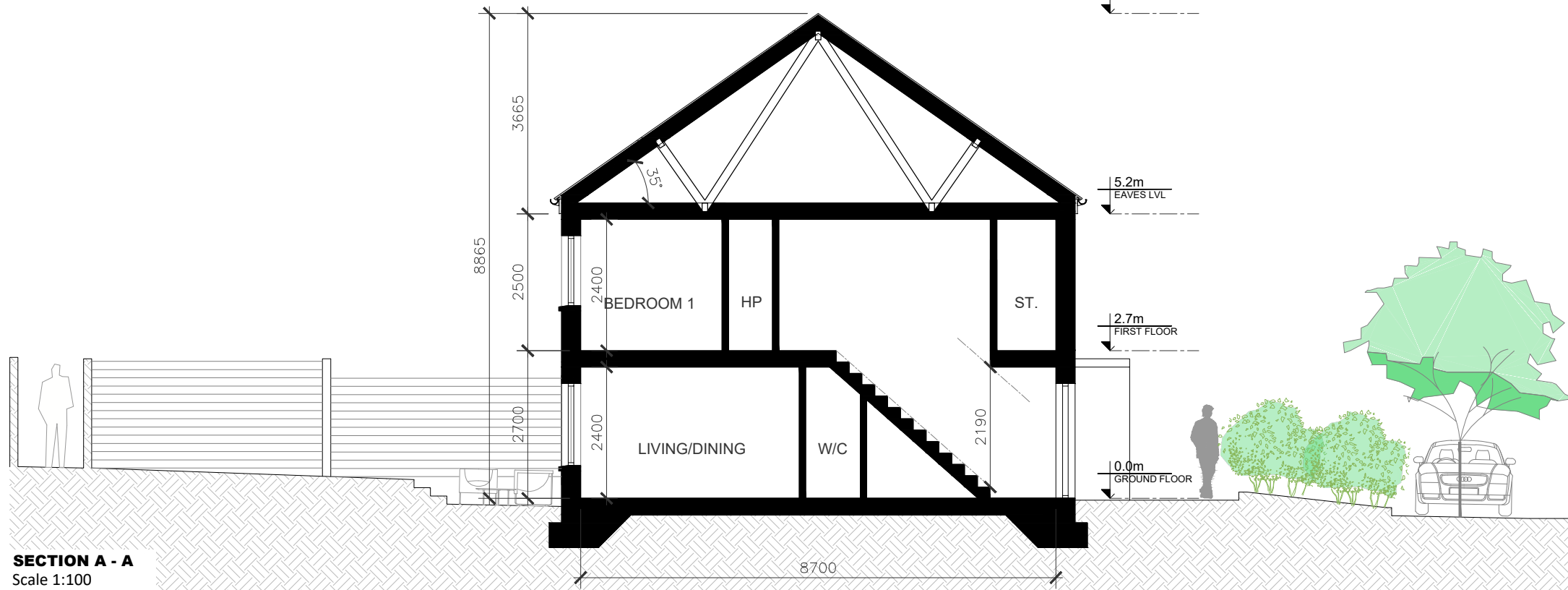

**SECTION A - A**  
Scale 1:100

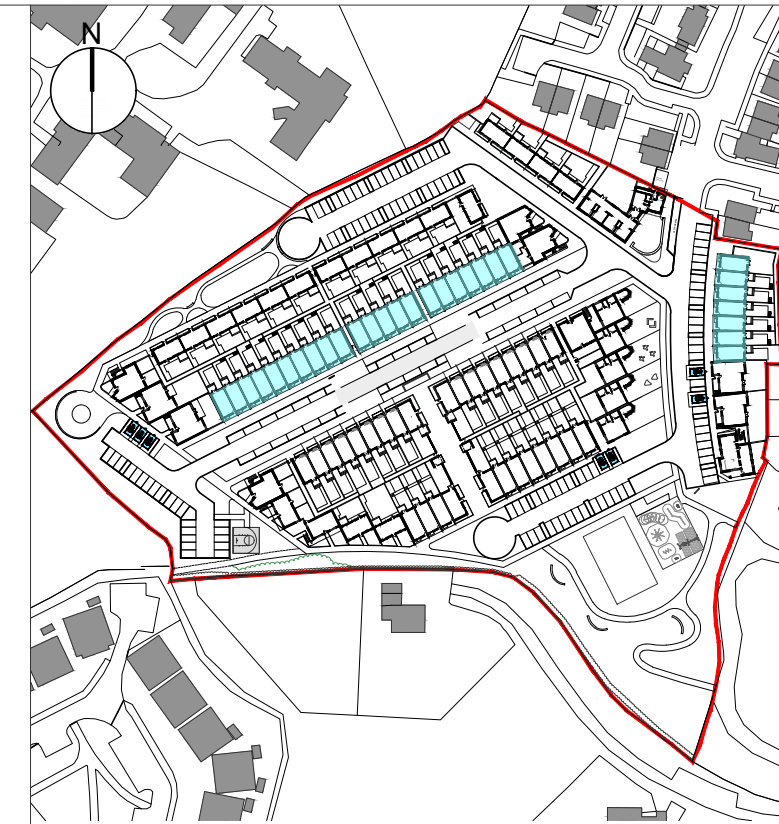

**KEY PLAN**  
1:2500

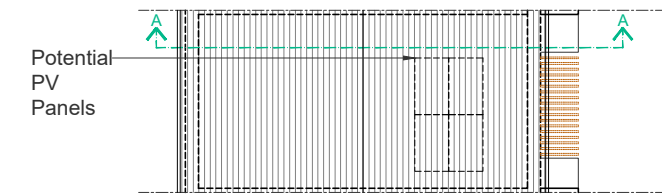

**ROOF PLAN**  
Scale 1:200

2B / 4P / 2S House		
	Minimum ( m <sup>2</sup> )	Proposed ( m <sup>2</sup> )
Floor Area	80	80.0
Main Living Area	13	18.5
Agg. Living Area	30	30.2
Agg. Bedroom Area	25	25.1
Storage	4	4.1
Private Open Space	50%	varies - see site

**A1910 House 02**

DESCRIPTION	CHK	STA	DATE	REV
	J.B	01	00/00/00	

**NOTE:**  
This drawing is for information purposes only.  
Information shown addresses current planning acts. This drawing is not intended to demonstrate compliance with the current building regulations nor is it intended for construction purposes.  
Do not scale from this drawing. Work only from figured dimensions. All errors and omissions to be reported to the architect.

<b>PROJECT:</b> Merlin Woods Social & Affordable Development	<b>DRAWING:</b> Part VIII Application House 02 GA's	<b>JOB NO.:</b> A-1910
<b>SITE:</b> Merlin Park Galway	<b>SCALE:</b> 1:100 @ A3	<b>DWG REF.:</b> A1910-GCC-DR-A-S3-105
<b>CLIENT:</b> Galway City Council	<b>DRAWN BY:</b> L.F.	<b>APPROVED:</b> E.H.
		<b>DATE:</b> June 2021
		<b>REV.:</b> -
		<b>WORK STAGE:</b> 3