

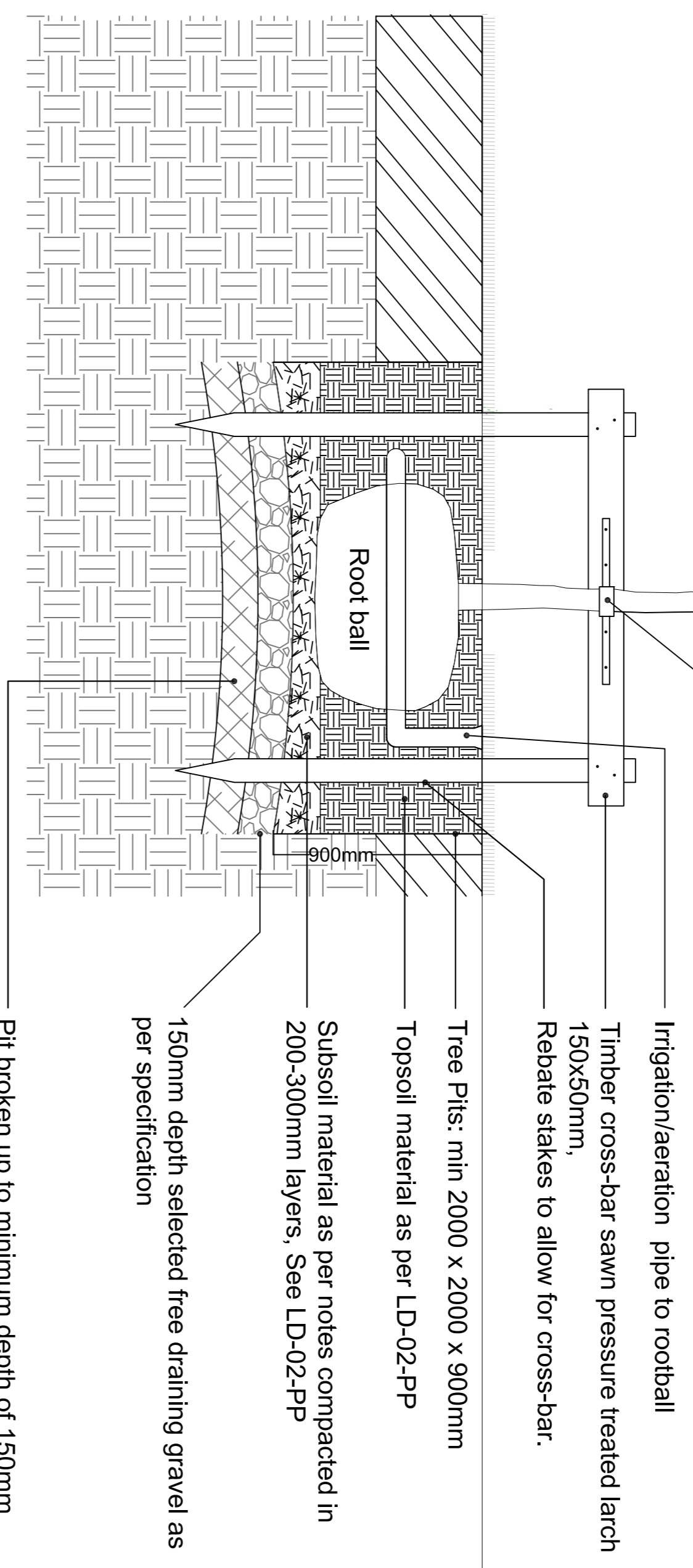

Note
See the planting plans for all planting species, type, quantity, location and density. See LD-02-PP for topsoil depths. See Softworks Specification for all planting and aftercare details.

The tree is to be secured to the cross-bar using 1no. rubber felt back block secured with rubber belting tie. Rubber belting tie fixed with 4no. clout nails. Ties are to be secured so as to allow for movement but prevent damage to the trunk.



Subsoil material as per notes compacted in 200-300mm layers. See LD-02-PP
 150mm depth selected free draining gravel as per specification
 Pit broken up to minimum depth of 150mm

- Planting Notes:**
1. At the time of planting, the soil shall be moist and friable and not frozen, excessively dry, or water-logged.
 2. The excavated hole shall be of sufficient size to accommodate the spread roots and the stock shall be planted so that after any settlement it is the same depth as it was grown in the nursery. The sides and base of the planting pit shall broken up before planting.
 3. The planting hole shall be backfilled around the plant, the soil shall be firmed to ensure that there is good contact between the plant roots and soil substrate.
 4. Water plants once planted.

- General Notes:**
1. At the time of planting, the soil shall be moist and friable and not frozen, excessively dry, or water-logged.
 2. The excavated hole shall be of sufficient size to accommodate the rootball and the stock shall be planted so that after any settlement it is the same depth as it was grown in the nursery. The sides and base of the planting pit shall broken up before planting.
 3. The planting hole shall be backfilled around the plant, the soil shall be lightly firmed to ensure that there is good contact between the rootball and soil substrate.
- Notes:**
4. The tree pit should be excavated to allow adequate clearance between the perimeter of the root-ball and the side of the pit. Minimum dimension 1200 x 1200mm
 5. The depth of the pit should be a minimum of 750mm and at least 75mm greater than the depth of the root-ball.
 6. Fork the bottom and sides of the pit to break up the subsoil.
 7. Mix the dug soil with a slow release fertiliser and an approved soil ameliorant.
 8. Drive in the stakes vertically on either side of the tree position before planting so that they are a minimum of 300mm below the bottom of the pit and 650mm above ground level.
 9. The stakes are to be machine rounded sweet chestnut or peeled larch poles, pointed at one end, preserved to resist rot for their intended lifespan, and strong enough to take nails without splitting.
 10. Plant the tree, ensuring that the original depth is maintained and the soil is carefully firmed back up to the existing ground level. Consolidate the backfill material around the stakes during backfilling.
 11. Secure the cross bar to the stakes with ZINC galvanised nails per stake. Secure the tree to the rail as described in the notes above.
 12. Secure trees to crossbar using rubber felt back block and rubber belting tie.
 13. Protect the tree stem from damage etc. by using a spiral rubber guard (if specified).
 14. The stakes and ball tie to be removed after 12 months or as specified by the tree supplier (at the start of the second growing season after planting).

Planting notes to all planted areas:

Detail D 01 Drawing LD-01-PP
Tree Pit Detail to open space areas
Scale @ 1:25

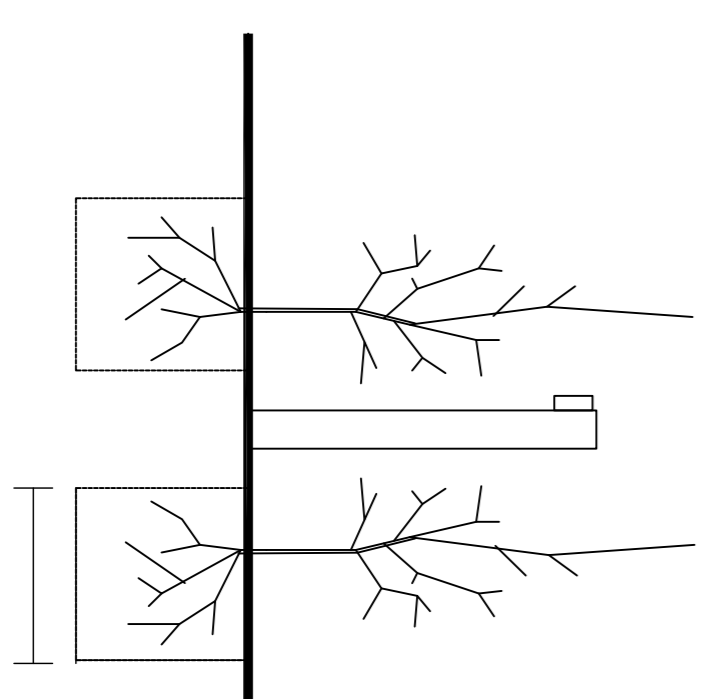
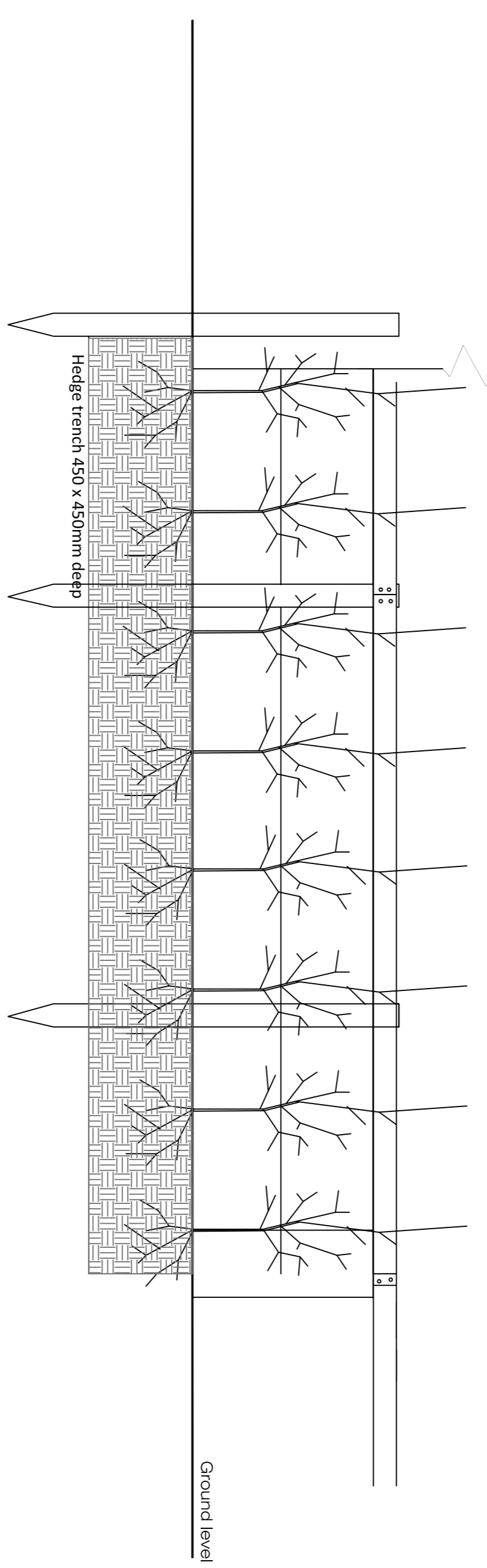
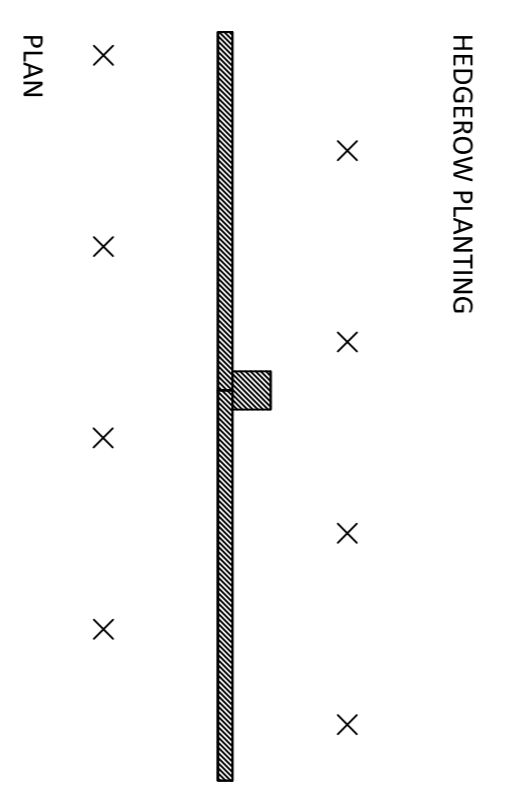

Note:
900 mm high sheep netting wire post stapled and fixed to line wires

Sheep netting:
Light grade wire, 1200mm high, 10 no. horizontal wires, 150mm verticals

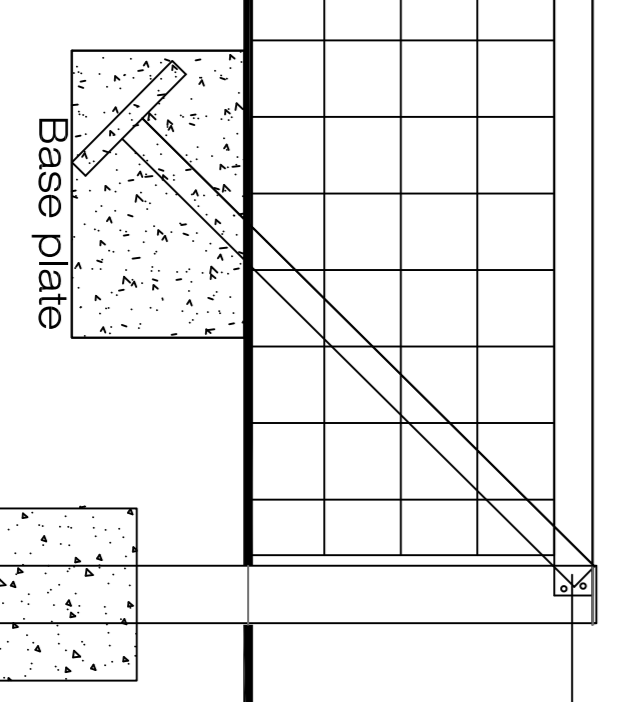

Note:
Backfill rammed soil or 50% concrete 50% rammed soil if no base plate is used

Straining post 150 mm diam. X 1650 mm set 800mm in ground and strut(s) in direction of strain 1700 mm X 75 mm diam. post notched.

1:2:4 concrete surround min 450mm dia. x 700mm

REV	DATE	BY	REASON

Project name: KEERAUN Social Housing	Project number: 21-009
Drawing name: Softworks Landscape Planting Details	Drawing number: LD-01-PP

Drawing scale @ A1: 1:20	Drawn by: d+o1	Checked by: dot
STATUS: Planning Application	DATE: 17.06.2021	

Contact details: Landscape Architecture Unit 10, The Old Coach House, 207 207 A 100 Dart Road, Dartmouth, Devon, TQ14 3JG t: 01803 820200 f: 01803 820201 e: info@doyleoTROITHIGH.com	Other address: 25-26 Upper Peninsula St Dartmouth TQ14 3JG
--	---

doyle + o'troithigh
 landscape - architecture
 www.doyleoTROITHIGH.com

Detail D 02 Drawing LD-01-PP
Hedge Planting Detail with Support Fence
Scale @ 1:20