

SCALE 1:250

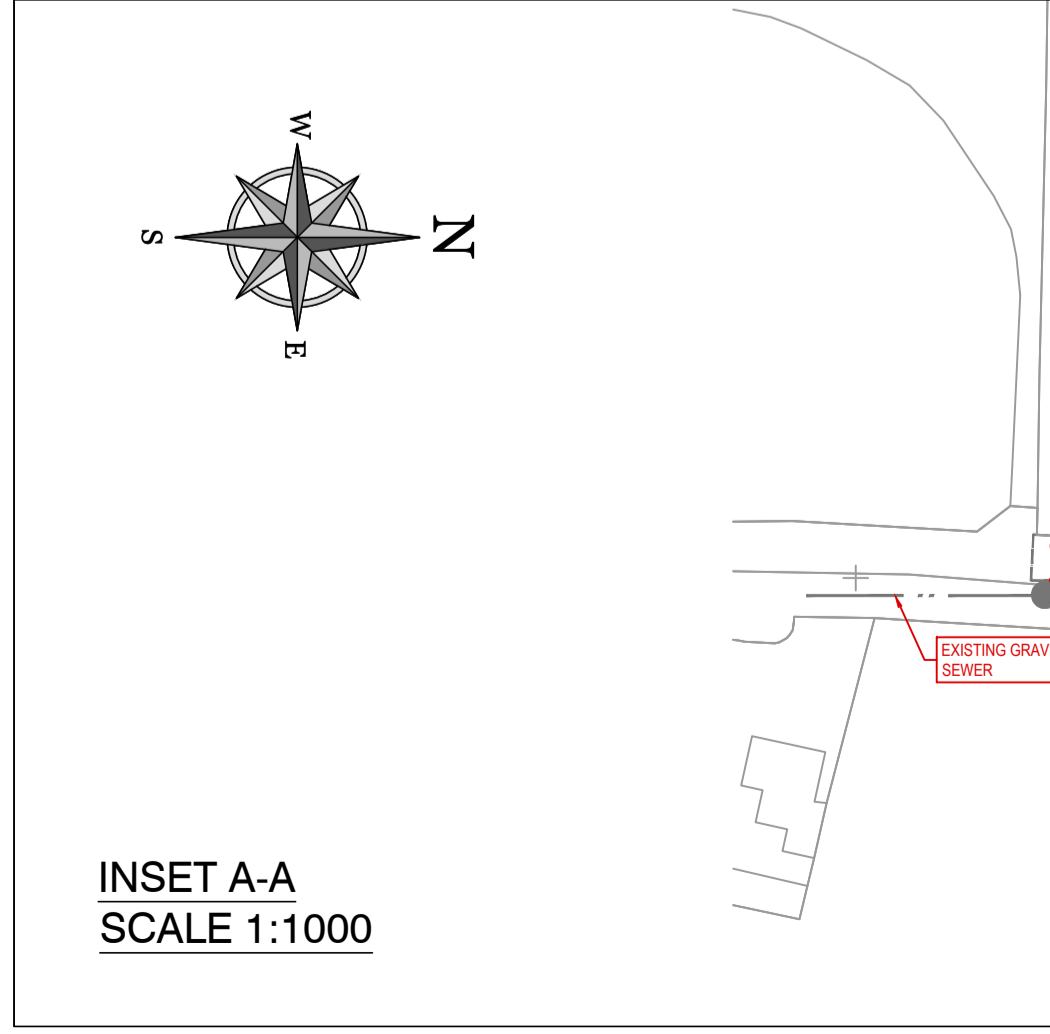

INSET A-A
SCALE 1:1000

FOUL NOTES

- LEVELS AND POSITIONS OF ALL EXISTING SERVICES TO BE CONFIRMED ON SITE PRIOR TO CONSTRUCTION.
- REFER TO ARCHITECT AND M&E ENGINEERS DRAWINGS FOR CURTILAGE DRAINAGE DETAILS, CURTILAGE DRAINAGE TO THE INTO INSPECTION CHAMBER INDICATED IN EACH BLOCK.
- CONTRACTOR TO PROVIDE AS-BUILT INFORMATION IN ACCORDANCE WITH IRISH WATER REQUIREMENTS.
- EXISTING FOUL & SURFACE WATER DRAINS & CONNECTIONS & WATER SUPPLY TO BE PRESERVED & UTILISED WHERE POSSIBLE.
- ALL EXTERNAL PRIVATE DRAINS TO BE 150MM DIA UNLESS NOTED OTHERWISE.
- FALLS IN FOUL SEWERS TO BE 1:60 UNLESS NOTED OTHERWISE.
- FALLS IN FOUL DRAINS FROM FINAL PRIVATE INSPECTION CHAMBERS TO BE BETWEEN 140 AND 180 IN ACCORDANCE WITH IRISH WATER STANDARD DETAIL STD-WW-03.
- ALL MAIN SEWERS WITH LESS THAN 1.2M COVER UNDER ROADS AND 0.5M COVER UNDER GRASS AREAS AND FOOTPATHS TO BE SURROUNDED IN 150MM C20 CONCRETE.
- PROVIDE MANHOLE COVERS AND AIS WITH ARCHITECTURAL FINISH WHERE REQUIRED. REFER TO ARCHITECTURAL PLANS FOR LOCATIONS.
- ALL COVERS IN PUBLIC AREAS TO BE IS EN 124 D400 UNLESS NOTED OTHERWISE.
- CE CERTIFICATION TO BE PROVIDED FOR ALL PRODUCTS COVERED BY THE EU CONSTRUCTION PRODUCTS REGULATION (NO.3052011-CPD).
- ALL MATERIALS PROPOSED FOR USE ON SITE TO BE APPROVED PRIOR TO ARRIVAL ON SITE.
- FOUL SEWER TO BE UNPLASTICISED PVC IN ACCORDANCE WITH SECTION 3.13 OF THE WASTEWATER CODE OF PRACTICE. UNPLASTICISED PVC PIPES AND FITTINGS SHALL COMPLY WITH THE PROVISIONS IN EN 1401 2009/012. PIPES TO BE APPLICATION AREA CODE 'U0'. STIFFNESS CLASS BKN12. PROVISION FOR JETTING SHALL BE BASED ON THE WRC SEWER JETTING CODE OF PRACTICE, JUNE 1997. PIPES TO BE CAPABLE OF RESISTING A MAXIMUM JETTING PUMP PRESSURE OF 2.60PSI (180 BAR) WITHOUT DAMAGE. (SEWER DIAMETERS 150MM UP TO 450MM, SERVICE CONNECTIONS OF 100MM DIAMETER).
- ALL WATER AND WASTEWATER INFRASTRUCTURE TO BE IN ACCORDANCE WITH IRISH WATER CODE OF PRACTICE AND STANDARD DETAILS.
- MANHOLE COVERS LOCATED IN GRASS AREAS SHALL BE SURROUNDED BY A CONCRETE PLINTH, 200mm ALL ROUND AND 100mm DEEP FORMED WITH C20/25 CONCRETE, 20mm AGGREGATE SIZE, BEDDED IN CLAUSE 804 MATERIAL.
- CONTRACTOR TO REFER TO SERVICE LAYOUT DISTANCES AS PER DETAIL STD-WW-05 IN IRISH WATER CODE OF PRACTICE. INSPECTION CHAMBERS TO BE IN ACCORDANCE WITH IRISH WATER STANDARD DETAIL STD-WW-02, STD-WW-03 AND STD-WW-13. MINIMUM DEPTH FL - 0.7m. MAXIMUM DEPTH 1.2m.
- CROSSING OF EXISTING AND NEW IRISH WATER INFRASTRUCTURE TO BE IN ACCORDANCE WITH IRISH WATER REQUIREMENTS AS PER SECTIONS 3.6.2 OF THE WATER CODE OF PRACTICE AND 3.5.19 OF THE WASTEWATER CODE OF PRACTICE.
- ALL WORKS TO BE UNDERTAKEN IN ACCORDANCE WITH:
 - T1 SPECIFICATION FOR ROADWORKS
 - GREATER DUBLIN CODE OF PRACTICE FOR DRAINAGE WORKS
 - RECOMMENDATIONS FOR SITE DEVELOPMENT WORKS
 - IRISH WATER CODE OF PRACTICE FOR WASTEWATER INFRASTRUCTURE AND WASTEWATER INFRASTRUCTURE STANDARD DETAILS
 - IRISH WATER CONNECTION AGREEMENT
 - BUILDING REGULATIONS - TECHNICAL GUIDANCE DOCUMENT H

WATERMAIN NOTES

- ALL DIMENSION AND LEVELS IN METERS, EXCEPT IF NOTED OTHERWISE.
- ALL LEVELS TO MALIN HEAD DATUM.
- COORDINATE SYSTEM IS: IRISH TRANSVERSE MERCATOR.
- LEVELS AND POSITIONS OF ALL EXISTING SERVICES TO BE CONFIRMED ON SITE PRIOR TO CONSTRUCTION.
- IRISH WATER CODE OF PRACTICE FOR WASTEWATER INFRASTRUCTURE AND WASTEWATER INFRASTRUCTURE STANDARD DETAILS.
- SERVICE CONNECTIONS TO BE HPPE (TYPE PE100-SDR17) OR MDPE (TYPE PE80-SDR11). SPECIFICATION SHALL BE IN ACCORDANCE WITH SECTION 3.9 OF IRISH WATER CODE OF PRACTICE.
- COVER TO WATERMAIN TO BE MINIMUM 900MM.
- COVER TO SERVICE CONNECTIONS TO BE MINIMUM 250MM.
- HYDRANTS TO BE 50MM & 450MM MAXIMUM FROM BUILDINGS.
- ALL COVERS IN PUBLIC AREAS TO BE IS EN 124 D400 UNLESS NOTED OTHERWISE.
- SPIGOT SOCKET CONNECTIONS TO BE USED AT PVC/DUCTILE IRON JUNCTIONS.
- ANCHOR BLOCKS TO BE POSITIONED AT DEAD ENDS, TEES, BENDS AND AT EACH SIDE OF HYDRANTS AND VALVES.
- FOR APARTMENTS BLOCKS, A METER WILL BE INSTALLED INTERNALLY WITHIN THE PREMISES IN ACCORDANCE WITH THE BUILDING CONTROLS AUTHORITY REQUIREMENTS AND SUBJECT TO REVIEW BY IRISH WATER. SEE SECTION 3.15.2 OF THE IRISH WATER CODE OF PRACTICE.
- ALL WORKS TO BE UNDERTAKEN IN ACCORDANCE WITH THE BUILDING CONTROLS AUTHORITY REQUIREMENTS AND SUBJECT TO REVIEW BY IRISH WATER. SEE SECTION 3.15.2 OF THE IRISH WATER CODE OF PRACTICE.
- BULK METERS ARE TO BE PROVIDED WHERE THE DAILY DEMAND EXCEEDS 20M3 (EQUIVALENT OF 40 DOMESTIC UNITS) IN ACCORDANCE WITH SECTION 2.4.3 AND 2.6.5 OF THE IRISH WATER CODE OF PRACTICE.
- ANCHOR BLOCKS TO BE POSITIONED AT DEAD ENDS, TEES, BENDS AND AT EACH SIDE OF HYDRANTS AND VALVES.
- SLICE VALVES PROVIDED AT ALL JUNCTIONS. REFER TO SECTION 3.16.2 AND 3.5.39 OF THE IRISH WATER CODE OF PRACTICE.
- MEASURES TO BE PUT IN PLACE TO ENSURE NO CROSS CONTAMINATION OCCURS BETWEEN THE FIRE WATER STORAGE AND POTABLE WATER WITHIN THE SUPPLY INFRASTRUCTURE AS PER SECTION 1.19 OF THE IRISH WATER CODE OF PRACTICE. REFER TO M&E CONSULTANTS DRAWINGS FOR DETAILS.
- NEW WATERMANS UP TO AND INCLUDING 150mm IN DIAMETER SHALL NOT BE LAD WITHIN 3m OF AN EXISTING OR PROPOSED STRUCTURE. SEE SECTION 3.5.10 OF IRISH WATER CODE OF PRACTICE.
- ALL WORKS TO BE UNDERTAKEN IN ACCORDANCE WITH:
 - IRISH WATER CODE OF PRACTICE FOR WATER INFRASTRUCTURE
 - AND 'IRISH WATER INFRASTRUCTURE STANDARD DETAILS'
 - T1 SPECIFICATION FOR ROADWORKS
 - GREATER DUBLIN CODE OF PRACTICE FOR DRAINAGE WORKS
 - RECOMMENDATIONS FOR SITE DEVELOPMENT WORKS
- CE CERTIFICATION TO BE PROVIDED FOR ALL PRODUCTS COVERED BY THE EU CONSTRUCTION PRODUCTS REGULATION (NO.3052011-CPD).
- ALL MATERIALS PROPOSED FOR USE ON SITE TO BE APPROVED PRIOR TO ARRIVAL ON SITE.
- LEVELS AND POSITIONS OF ALL EXISTING SERVICES TO BE CONFIRMED ON SITE PRIOR TO CONSTRUCTION.
- REFER TO ARBORIST/LANDSCAPE ARCHITECT FOR ROOT PROTECTION DETAIL. ROOT PROTECTION WILL BE IN ACCORDANCE IRISH WATER STANDARD DETAIL STD-W-12A.

LEGEND:

- EXISTING 1500 RISING MAIN
- EXISTING 500 RISING MAIN
- EXISTING 1000 WATERMAIN
- SITE BOUNDARY

PROPOSED SERVICES:

- IC: FOUL WATER INSPECTION CHAMBER
- 225e: FOUL WATER SEWER
- IC: FOUL WATER MANHOLE
- IC: FOUL RISING MAIN & INSPECTION CHAMBER
- WATERMAIN
- BULK WATER METER
- HYDRANT
- SLICE VALVE
- BOUNDARY BOX
- AIR VALVE
- SCOUR VALVE
- BLOCK CONNECTIONS
- 225e 1:150: SURFACE WATER SEWER
- 225e 1:150: SURFACE WATER DRAIN
- S9 CL 100.00 IL 99.00: SURFACE WATER MANHOLE
- SWALE
- SURFACE WATER SOAKAWAY
- SINGLE GULLEY
- DOUBLE GULLEY
- FILTER DRAIN
- 22.200: EXISTING GROUND LEVEL CONTOUR & LABEL
- 16.900: PROPOSED ROAD LEVEL CONTOUR & LABEL

SURFACE WATER NOTES

- ALL DIMENSION AND LEVELS IN METERS, EXCEPT IF NOTED OTHERWISE.
- ALL LEVELS TO MALIN HEAD DATUM.
- COORDINATE SYSTEM IS: IRISH TRANSVERSE MERCATOR.
- LEVELS AND POSITIONS OF ALL EXISTING SERVICES TO BE CONFIRMED ON SITE PRIOR TO CONSTRUCTION.
- REFER TO ARCHITECT DRAWINGS FOR DETAILS ON PROPOSED AND EXISTING SITE SERVICES REFER TO ARCHITECT AND M&E ENGINEERS DRAWINGS FOR CURTILAGE DRAINAGE DETAILS. CURTILAGE DRAINAGE TO THE INTO INSPECTION CHAMBER INDICATED IN EACH BLOCKS.
- DRAWINGS BE READ IN CONJUNCTION WITH ARCHITECTS AND LANDSCAPE ARCHITECT DRAWINGS AND DETAILS.
- LEVEL, POSITION AND CONDITION OF ALL EXISTING SERVICES ARE TO BE CONFIRMED ON SITE PRIOR TO COMMENCEMENT OF CONSTRUCTION AND FININGS CONVENED TO THE DESIGN ENGINEER.
- EXISTING FOUL & SURFACE WATER DRAINS & CONNECTIONS & WATER SUPPLY TO BE PRESERVED & UTILISED WHERE POSSIBLE.
- ALL PUBLIC SEWER TO BE MINIMUM 225mm IN DIAMETER.
- DRAIN CONNECTIONS FROM FINAL PRIVATE INSPECTION CHAMBER TO BE MINIMUM 150MM @ 1:100 U.O.
- ALL MAIN SEWERS WITH LESS THAN 1.2M COVER UNDER ROADS AND 0.5M COVER UNDER GRASS AREAS AND FOOTPATHS TO BE SURROUNDED AND PROTECTED WITH CONCRETE IN ACCORDANCE WITH DBFL STANDARD DETAILS.
- MANHOLE COVERS AND SERVICE COVERS LOCATED IN BLOCK PAVED OR PAVING SLAB AREAS ARE TO HAVE RECESSED COVERS TO RECEIVE PAVINGS TO MATCH ADJACENT PAVING MATERIALS.
- CONTRACTOR TO DEVELOP AS-BUILT DRAWINGS AS PART OF CONSTRUCTION WORKS TO KCC REQUIREMENTS.
- ALL WORKS TO BE UNDERTAKEN IN ACCORDANCE WITH:
 - T1 SPECIFICATION FOR ROADWORKS
 - GREATER DUBLIN CODE OF PRACTICE FOR DRAINAGE WORKS
 - RECOMMENDATIONS FOR SITE DEVELOPMENT WORKS
- CE CERTIFICATION TO BE PROVIDED FOR ALL PRODUCTS COVERED BY THE EU CONSTRUCTION PRODUCTS REGULATION (NO.3052011-CPD).
- ALL MATERIALS PROPOSED FOR USE ON SITE TO BE APPROVED PRIOR TO ARRIVAL ON SITE.

POB	DATE	FOR	BY	CHKD
P06	24/05/22	FOR PLANNING	MVM	VEG
P05	17/05/22	REVISED SITE BOUNDARY	MVM	VEG
P04	05/04/22	PLANNING SUBMISSION	MVM	VEG
P03	28/03/22	FOR PLANNING	MVM	VEG
P02	21/10/21	ISSUED FOR STAGE 2A DRAFT	VEG	VEG
P01	06/09/21	ISSUED FOR STAGE 2A DRAFT	KGO	VEG

rev	date	A - description	by	chkd.
client approval		A - Approved		
		B - Approved with comments		
		C - Do not use		

client approval

submittal

S2 - INFORMATION

PLANNING

DBFL Consulting Engineers
Civil, Structural & Transportation Engineering
www.dbfl.ie

DUBLIN OFFICE: Ormond House, Upper Ormond Quay, Dublin 7, D07 W704
PHONE: +353 1 404 4000

CORK OFFICE: 14 South Mall, Cork, T12 CT91
PHONE: +353 21 202438

WATERFORD OFFICE: 54a-56 The Arkun, Waterford, W91 W028
PHONE: +353 51 309 500

project ref.

HEADFORD ROAD HOUSING, GALWAY

drawing title

COMBINED SERVICES LAYOUT

client

GALWAY CITY COUNCIL

designed by: VEG
drawing no: 190048-DBFL-CS-SP-DR-C-1301

author: MVM
scale: AS SHOWN
sheet size: A1

revision: P06

ORNDANCE SURVEY IRELAND LICENCE No EN 0017922
© ORNDANCE SURVEY IRELAND GOVERNMENT OF IRELAND